

REVISION RECORD				
REV	ECO	DESCRIPTION	DRFT	C

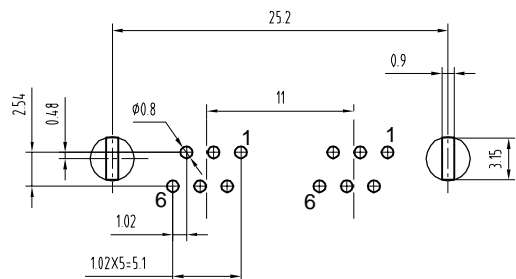
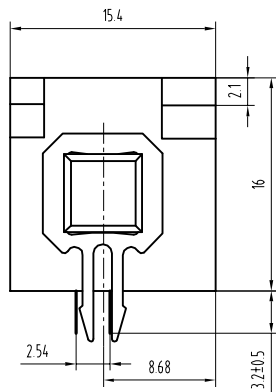
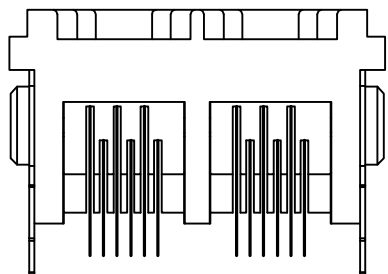
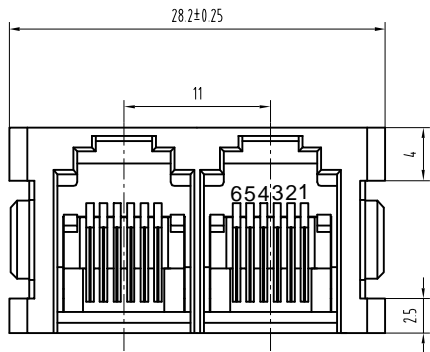

PC Board Layout  
Component Side Shown

NOTES:

MATERIAL :

- 1.HOUSING MATERIAL :GLASS FILLED POLYESTER UL94V-0.
- 2.CONTACT MATERIAL :PHOSPHOR BRONZE  $\phi 0.46\text{mm}$ .
- 3.PLATING :GOLD PLATING OVER NICKEL.

ELECTRICAL:

- 1.VOLTAGE RATING :125 VAC RMS.
- 2.CURRENT RATING :15 AMP.
- 3.CONTACT RESISTANCE :30 MILLIOHMS MAX.
- 4.INSULATION RESISTANCE :500 MEGOHMS MIN @ 500V DC .
- 5.DIELECTRIC WITHSTANDING RESISTANCE :1000V AC RMS 50Hz. 1MIN.

MECHANICAL:

- 1.DURRABILITY :750 CYCLES MIN.
- 2.PCB RETENTION PRE-SOLDER :1 LB MIN.

ENVIRONMENTAL:

- 1. STORAGE : -40°C~+85°C
- 2. OPERATION : 0°C TO 70°C.

		DFTO <b>SHB</b> DATE <b>2007.05.03</b>	<h1>Coorle库乐科技</h1>	
TOLERANCES EXCEPT AS NOTED		CHKD <b>LAMBO</b> DATE <b>2007.05.03</b>		
DETAILED LISTS	MM	MFO	DATE	TITLE <b>5225 JACK 180° 6P6C 1*2</b>
	.1 ± 0.15	APPL	DATE	
	.08 ± 0.075	MATERIAL :		
	.001 ± 0.05	QTY :		
ANGLES ± 0.5		FINISH :		DRAWING NO. <b>TESSD1001</b>
		SCALE :		/PART NO. <b>A3</b>
DD NOT SCALE DRAWING			SHEET <b>X</b>	OF